

Installation instructions

Please read these instructions carefully. DC SHORT LTD cannot be held responsible if the installation and use of the towel rail is not carried out in accordance with the instructions given below or for materials not supplied by DC SHORT LTD.

SAFETY

The towel rail is not intended for use by young children or infirm persons without supervision. Young children should be supervised to ensure that they do not play with the appliance. The towel rail has been designed to withstand the loads expected during normal operation as a towel rail. The towel rail is not a ladder and should not be used as such.

ELECTRICAL

The towel rail must be wired by a registered electrician and must be earthed. An isolating switch must be positioned near the towel rail. If the supply cord is damaged the entire towel rail must be returned to DC SHORT LTD for repair.

WALL MOUNTING

The towel rail is designed to be fixed through wall cladding into solid wall framing, solid cementitious, or masonry walls. Plasterboard toggles, of at least 3mm diameter, may be used for 2 of the towel rail fixings. The recommended installation height is 1600mm from the floor to the top of the rail.

CARE & CLEANING

Do not use cream cleansers. Do not use spray on detergents. Use a soft cloth and warm soapy water or a silicone based household wax/polish such as SC Johnson 'Pledge' for general polishing and cleaning of the appliance. Fine scratching can be removed using the correct metal polish. Recommended brands are 'Autosol' and 'Brasso Paste', both available in tubes from supermarkets and car care outlets.

SPECIFICATION

Voltage	230V AC 50Hz
Power	60W - 200W *
Width	450 - 665mm *
Height	475 - 1760mm *

*(see product specification marked on the product and packaging for information applicable to your purchase)

INSTALLATION

- Place the towel rail against the wall in the desired position, to line up with wall framing where applicable.
- Using a fine pencil, or by gently pressing the rail against the wall, mark the position of all four rail legs.. See fig 1.0

IMPORTANT

- Ensure that all four legs touch the wall when the towel rail is in the correct position against the wall.
- A gap of no more than 2mm is ideal. see Fig 2.0
- If there is an excessive gap, one of the legs could be recessed to correct the wall alignment. see Fig 3.0
- Do not be tempted to flex the towel rail to close a large gap during final assembly as this will damage the towel rail and/or the mounting inserts.

INSTALLATION NOTES CONTINUED OVER PAGE...

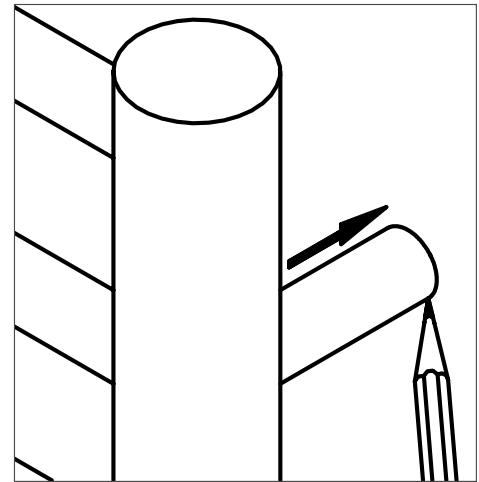

Fig 1.0

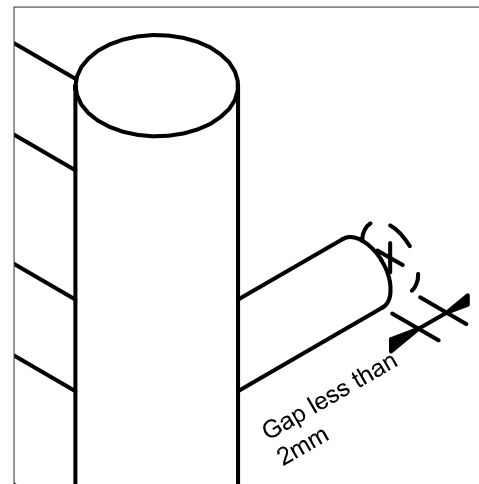

Fig 2.0

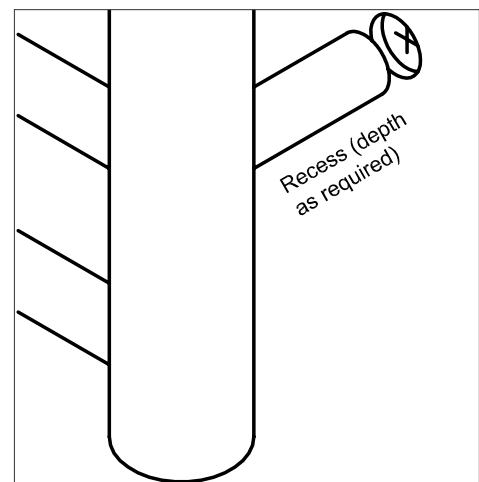

Fig 3.0

Installation instructions

Ladder

INSTALLATION CONTINUED...

- Screw the mounting inserts securely to the wall at the locations marked. see Fig 4.0
- A small amount of vaseline applied to each mounting insert at this time will make assembly easier.
- Press the towel rail onto the mounting inserts gradually, checking that each leg is lined up with the mounting inserts before applying force. see Fig 5.0
- Screw self tapping screws into each of the four legs so that the rail is securely fixed. see Fig 6.0

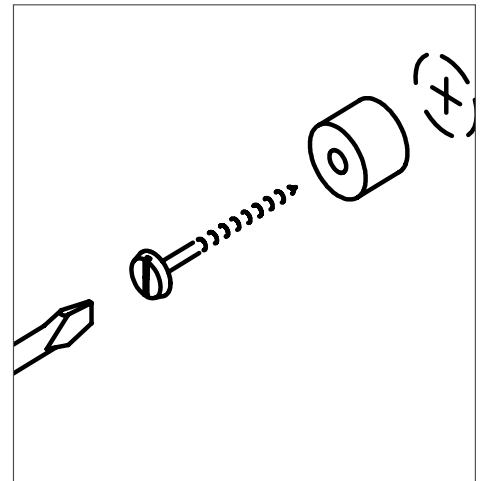

Fig 4.0

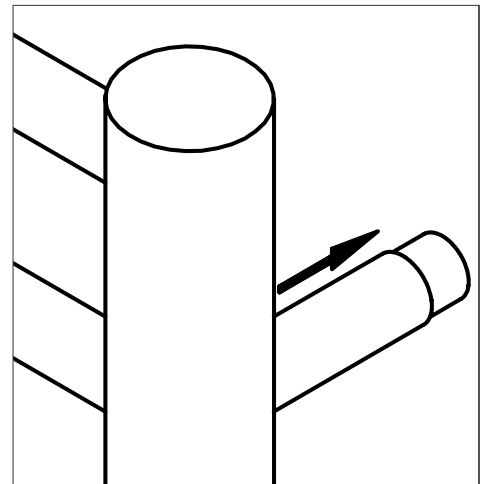

Fig 5.0

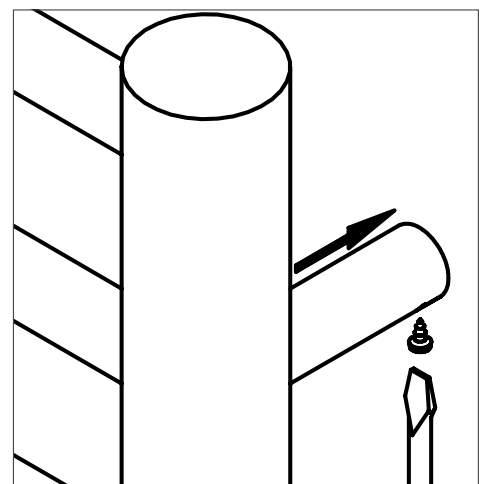

Fig 6.0

Warranty

DC Short Ltd warrants the purchaser against defects in workmanship and material for a period of twenty four (24) months from the date of original purchase. Purchase receipts for this product are to be retained as proof of purchase and must be presented if making a claim under the terms of the DC Short Ltd warranty. DC Short Ltd reserves the right to repair or replace the appliance within the warranty period. This warranty does not extend to accessories or defects or injuries caused by or resulting from causes not attributable to faulty parts or the manufacture of the product, including but not limited to, defect or injury caused by or resulting from misuse, abuse, neglect, accidental damage, improper voltage, liquid spillage, vermin infestation, software, or any alterations made to the product which are not authorized by DC Short Ltd. In Australia, this warranty is in addition to the conditions and guarantees which are mandatory as implied by the Trade Practices Act 1974 and State and Territory legislation.